



Technical informations

Length	14.95 mètres
Width	3.85 mètres
Recommended capacity	8
Number of cabins	4
Bathrool / Toilette	1
Size Livingroom	7 m ²
Kitchen equipment	130 L fridge (freezer compartment), Twin-hob stove/oven
Drinking Water Reservoir	1050 L
Propulsion energy	diesel
Fuel tank	375 L
Double steering	Yes
Bow thruster	Yes
Other equipment	220-volt shore power supply, Radio CD/MP3, Terrace with garden furniture on request



The Octo Fly is a river cruiser that ideally accommodates four couples or three couples with two children.

The Nicols Octo Fly from the Fly range is 15 metres long and is the largest model (or "flagship boat") produced in the Nicols boatyards. Thanks to its bow propeller, piloting the Octo Fly is child's play.

This river cruiser comes with four cabins and four bathrooms and offers the highest-level of comfort you can find on the river tourism market with a large fridge, hob and oven, satellite television, radio/CD/MP3 player and 220-Volt shore power supply.

The boat has a covered aft terrace with garden furniture and access to the upper deck where you will find a dining area with an outdoor kitchen (sink, plancha grill) under the shade of a bimini top, a second outdoor cockpit and two deck cushions for lounging outside. As with the other boats in the Estivale range, swimmers will be delighted to find a boarding ladder and a deck shower. Don't wait any longer to cast off on this licence-free houseboat with extraordinary features!

[>> View the PDF brochure](#)

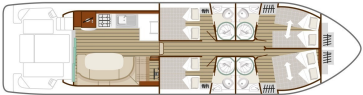
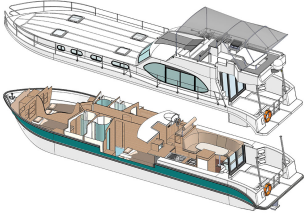



Customize your boat

Product Sellerie simili-cuir

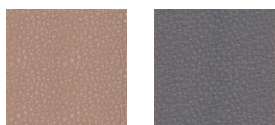

Product Revêtement du sol

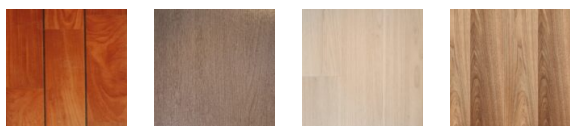

Product Voilage

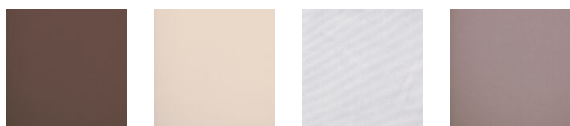

Product Sellerie tissu

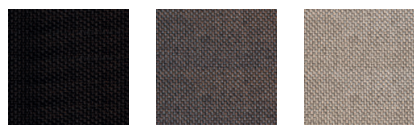

Product Menuiserie



Product Bimini-top



Technical Description



MATERIALS

- White-coloured polyester for deck and flying bridge
- White-coloured polyester and sea-green stripe for hull

INTERIOR MATERIALS

- Partition walls: water-repellent melamine chipboard, "light oak" colour, 16 mm
- Counter-moulded ceiling in polyester, ivory RAL 1013 colour
- Single-unit shower room, polyester, ivory RAL 1013 colour
- PVC floor covering in "medium walnut" colour
- Hull bottom frames and structures: joinery deal and CTBX plywood, 19 and 40 mm
- Mattress and seat top in high-density 15 cm thick foam, covered in leatherette

FITTINGS

- Handrail in stainless steel tubing, diameter 20
- 1 fore railing in 2 sections with intermediary tubing and fore passage (stainless steel, diameter 23)
- 1 aft guardrail with 2 opening gates (stainless steel tubing, diameter 23)
- 4 reinforced chandeliers
- 10 single chandeliers
- 2 rows of railings (sheathed stainless steel) to starboard and port side
- 6 x 250 cleats (anodised alu)
- 4 navigation lights
- 3 black PVC sheer rails attached to the hull, incl. 1 at level of hull/deck connection
- 2 gangway supports in opening of side gates
- 1 aluminium gangway
- 1 roller support for anchor chain
- 1 electric windscreen wiper
- 1 audio warning device
- Fly equipped with handrails

MOTORISATION

- 1 x 50 CV in-board diesel motor (shaftline) equipped with a hydraulic shutter with flexible coupling
- 1 x 295 L fuel tank
- 1 x 2-station hydraulic steering system
- *Main cockpit (saloon)*: 1 mono-lever gas compartment, 1 tachometer, 1 fuel indicator, 1 hour meter, 1 rudder angle indicator, 1 engine oil temperature indicator, 1 battery-level indicator and 1 waste water tank level indicator.
- *Secondary cockpit (flying bridge)*: 1 mono-lever gas compartment, 1 tachometer, 1 rudder angle indicator.
- 1 engine hold with sound-insulating foam

BOW THRUSTER

- 80 kg fore thruster
- 80 kg aft thruster
- Single control for both thrusters

WASTE WATER STORAGE



- 2 stainless steel double tanks with a total capacity of 400 litres
- 1 deck drain for emptying tanks

INTERIOR EQUIPMENT

Saloon

- 1 two-seat “pilot” bench
- 1 windscreen demisting fan heater
- 1 “C”-shaped bench, convertible into a double bed
- 1 beige coloured polyester table
- 1 electric refrigerator / freezer, 220 L, 220 volts
- 1 single-bowl sink (100 x 60) with draining board and mixer tap
- 1 x 4-hob hotplate with piezzo electric ignition
- 1 kitchen unit in 16-mm thick “light oak” coloured water-repellent chipboard
- 1 oven (gas-powered)
- 1 automatic bin door
- Curtains with blackout lining
- 1 x 22” LCD colour TV with DVD player – Satellite reception
- 1 Bluetooth FUSION radio – USB player – 2 speakers
- 220 V socket
- USB port

2 fore cabins

- 1 x 140×190 double bed convertible into 2 single beds with high-density 15 cm thick foam mattress
- Storage compartment under bed
- Wardrobe
- Storage units
- 2 opening portholes
- 2 square opening deck hatches
- Direct access to shower room and WC
- Mosquito screen/roll-up blind combination
- LED bedside lamps
- 220 V socket
- USB port

2 aft cabins

- 1 x 140×190 double bed with 15 cm thick foam mattress
- Storage compartment under bed
- Storage units
- 2 opening portholes
- 2 square opening deck hatches
- Direct access to shower room and WC
- Mosquito screen/roll-up blind combination
- LED bedside lamps
- 220 V socket
- USB port

4 shower cubicles – WCs

- 1 full round shower with access via 2 sliding doors in green-tinted Plexiglas and thermostatic tap



- 1 ceramic electric marine WC
- 1 beige polyester washbowl with mixer tap
- 1 storage unit
- 2 coat hooks
- 1 sliding porthole with opaque film on window and mosquito screen
- 1 solar ventilator
- LED spotlighting

EXTERIOR EQUIPMENT

- 1 bimini with extension
- 1 deck shower head accessible from aft platform
- Under-fly lighting with LED spotlights
- 1 swimming ladder
- 2 hook housings
- 1 fixed stairway for flying bridge access
- 2 spotlights integrated in the hull

FLY EQUIPMENT

- Large bench seat moulded into the fly
- Sun lounger with folding backrest
- Pilot bench and co-pilot bench
- LED ambient lighting
- Gas plancha grill
- Sink
- White polyester panel convertible into a large sunbathing deck
- Glass/can holder
- Remote control for the radio
- Waterproof speakers

WINDOWS – OPENINGS

- 1 curved safety glass windscreen, 5 mm, in 5 parts, incl. 2 opening
- Saloon sliding bay windows in 4 mm green-tinted safety glass and surrounding profile in lacquered aluminium
- Aft sliding bay window, 3 casements in grey lacquered aluminium
- Fixed and opening portholes in green-tinted glass, grey lacquered aluminium frame
- 4 square opening deck hatches, green-tinted

SERVICES

Energy

- 1 x 100 AH battery (engine starting)
- 2 x 100 AH slow discharge batteries (electric fore thruster)
- 2 x 100 AH slow discharge batteries (electric aft thruster)
- 2 x 100 AH slow discharge batteries (services)
- 3 x 100 AH slow discharge batteries (refrigerator)
- 2 x 2-way charge separator
- 2 x 25 AH battery charger
- 2 x 220-volt shore power supply sockets
- 1 x 2,500 W converter



Drainage

- 1 switch + 1 engine hold pump
- 1 switch + 1 fore shower pump
- 1 switch + 1 keel pump
- 1 switch + 1 propeller compartment pump

Water

- 1,050 litre water tank, incl. 75 litre hot water tank
- Pressurised hot water and cold water with accumulator tank
- Hot water production with lagged 75-litre heat exchanger tank
- 1,200 W water heater element on shore power supply

Gas

- 2 self-emptying gas compartments for 13 kg cylinders

Heating

- 2 WEBASTO AIR TOP 55 forced-air heating systems

Air conditioning

- No air conditioning.

Lighting

- Lighting via recessed LED spotlights, directional LED spotlights and LED wall lights.
- Two-way switch lighting in the fore cabins, corridor and saloon



Our contact informations

Are you interested in this model and would you like more information? **Do not hesitate to contact us. Nicols**
Route du Puy Saint Bonnet 49300 Cholet - France **02 41 56 46 56**

