



## Technical informations

Length	13.5 mètres
Width	3.8 mètres
Recommended capacity	8
Number of cabins	4
Bathroom / Toilette	2
Size Livingroom	11 m <sup>2</sup>
Kitchen equipment	220 L fridge (freezer compartment), Twin-hob stove/oven
Drinking Water Reservoir	1150 L
Propulsion energy	diesel
Fuel tank	315 L
Double steering	Yes
Bow thruster	Yes
Other equipment	220-volt shore power supply, Boarding ladder + outdoor shower, DVD player, Radio CD/MP3, Terrace with garden furniture



With its four comfortable cabins, it can accommodate up to ten people.

The Nicols OCTO, part of the new “Estivale” generation, was designed in 2009. With its four cabins (including convertible beds: either double or twin-sized), it is ideal for four couples or two couples with four children. It comes with an aft terrace window level with the living quarters (access via a large sliding bay door), a popular feature that is also included with the Sedan range.

The aft terrace enjoys a deck saloon for outdoor dining, and is equipped with a sun awning if you need protection from the rays! Also to the aft is the classic gate enabling wide access from a jetty to the terrace. The Estivale range has an extra advantage: two side gates, moulded into the hull, have been added to make it easier to get off the boat from the sides. Highly practical, particularly for “wild” mooring! Simply lay the gangway to disembark onto the bank.

Access to the roof solarium is gained via a moulded stairway + handrail (for comfort and security). The upper deck offers a second jet-ski-style “collapsible” cockpit to facilitate its use while seated on the bench. To the fore of the boat, a second small terrace moulded into the hull offers a bench and table to make the most of an unobstructed view of the river while sailing.

Lastly, there is a wide range of amenities on board to ensure the greatest possible convenience. This includes spacious bathrooms with a built-in shower stall and towel dryers!

In the living quarters, you will find an LCD TV with a DVD player and a radio/CD/MP3 player. You will also find that the kitchen is well furnished for your convenience with a 220 L fridge and freezer compartment, a four-burner hob and oven/grill as well as the new addition of a mini bar! Not forgetting all the other great features, such as the 220 volt shore power supply, swimming ladder, etc.

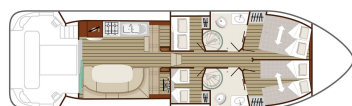
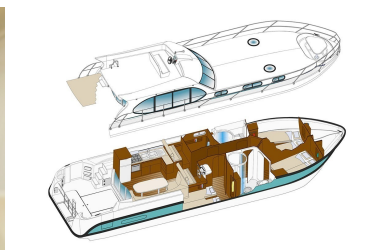
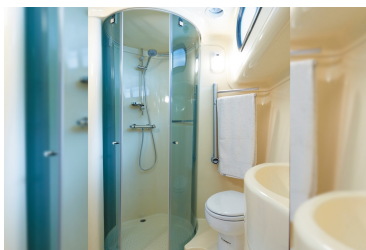



## Technical Description

### MATERIALS

- White-coloured polyester for deck and flying bridge
- White-coloured polyester and sea-green stripe for hull

### INTERIOR MATERIALS

- Partition walls: water-repellent melamine chipboard, "light oak" colour, 16 mm
- Counter-moulded ceiling in polyester, ivory RAL 1013 colour
- Single-unit shower room, polyester, ivory RAL 1013 colour
- PVC floor covering in "medium walnut" colour
- Hull bottom frames and structures: joinery deal and CTBX plywood, 19 and 40 mm
- Mattress and seat top in high-density 10 cm thick foam, covered in leatherette

### FITTINGS

- Handrail in stainless steel tubing, diameter 20
- 1 fore railing in 2 sections with intermediary tubing and fore passage (stainless steel, diameter 23)
- 1 aft guardrail with 2 opening gates (stainless steel tubing, diameter 23)
- 2 reinforced chandeliers
- 6 single chandeliers
- 2 rows of railings (sheathed stainless steel) to starboard and port side
- 4 x 250 cleats (anodised alu)
- 4 navigation lights
- 2 black PVC sheer rails attached to the hull, including 1 at hull/deck connection level (3rd sheer rail as optional extra)
- 2 gangway supports in opening of side gates
- 1 aluminium gangway
- 1 roller support for anchor chain
- 1 polyester table on aluminium base in the fore cockpit
- 1 electric windscreen wiper
- 1 audio warning device

### MOTORISATION

- 1 x 50 CV in-board diesel motor (shaftline) equipped with a hydraulic shutter with flexible coupling
- 1 x 315 L fuel tank
- 1 x 2-station hydraulic steering system
- *Main cockpit (saloon)*: 1 mono-lever gas compartment, 1 tachometer, 1 fuel indicator, 1 hour meter, 1 rudder angle indicator, 1 sensitive bow thruster control, 1 engine oil temperature indicator, 1 battery-level indicator and 1 waste water tank level indicator.
- *Secondary cockpit (flying bridge)*: 1 mono-lever gas compartment, 1 tachometer, 1 rudder angle indicator, 1 sensitive bow thruster control.
- 1 engine hold with sound-insulating foam

### WASTE WATER STORAGE



- 2 double tanks with a total capacity of 240 litres
- 1 deck drain for emptying tanks

## INTERIOR EQUIPMENT

### Saloon

- 1 two-seat "pilot" bench
- 1 two-seat "co-pilot" bench, collapsible for extended work area
- 1 windscreen demisting fan heater
- 1 "C"-shaped bench, convertible into a double bed
- 1 beige coloured polyester table
- 1 electric refrigerator / freezer, 220 L, 220 volts
- 1 twin-bowl sink (120 x 60) with draining board and mixer tap
- 1 x 4-hob hotplate with piezzo electric ignition
- 1 kitchen unit in 16-mm thick "light oak" coloured water-repellent chipboard
- 1 oven (gas-powered)
- 1 automatic bin door
- 1 x 19-inch LCD colour television with DVD player
- 1 radio CD-MP3 USB player – 2 speakers
- Fabric curtains with blackout lining
- 220 V socket
- USB port

### 2 fore bedrooms

- 2 single beds convertible into a 140×190 double bed with 15 cm thick foam mattress
- Storage compartment under bed
- Wardrobes
- Storage units
- 1 opening porthole
- 1 round opening deck hatch
- Direct access to shower room and WC
- Fabric curtains with blackout lining
- Bedside lamp
- 220 V socket
- USB port

### 2 aft bedrooms

- 1 x 140×190 double bed with 15 cm thick foam mattress
- Storage compartment under bed
- Wardrobes
- Storage units
- 1 opening porthole
- Fabric curtains with blackout lining
- Bedside lamp
- 220 V socket
- USB port

### Bathroom – WC

- 1 full round shower with access via 2 sliding doors in green-tinted Plexiglas and thermostatic tap



- 1 electric marine WC
- 1 beige polyester washbowl with mixer tap
- 1 storage unit
- 1 hot-air towel dryer
- 1 mirror
- 2 coat hooks
- 1 sliding porthole with opaque film on window
- 1 solar ventilator

## EXTERIOR EQUIPMENT

- 1 sliding sun awning
- Mosquito screen on bedroom and shower-room portholes
- 1 deck shower head accessible from aft platform
- Flying bridge dashboard fitted with a map holder
- 2 exterior lamps
- 1 swimming ladder
- 2 solar ventilators
- 2 hook housings
- 2 large polyester side gates
- 1 fixed stairway for flying bridge access
- 1 fore terrace moulded into the deck
- 2 spotlights integrated in the hull

## WINDOWS – OPENINGS

- 1 curved safety glass windscreen, 5 mm, in 5 parts, incl. 2 opening
- Saloon sliding bay windows in 4 mm green-tinted safety glass and surrounding profile in lacquered aluminium
- Aft sliding bay window, 3 casements in white lacquered aluminium
- Fixed and opening portholes in green-tinted glass, grey lacquered aluminium frame
- 2 round opening deck hatches, green-tinted

## SERVICES

### Energy

- 1 x 100 AH battery (engine starting)
- 2 x 100 AH slow discharge batteries (electric thruster)
- 2 x 100 AH slow discharge batteries (services)
- 3 x 100 AH slow discharge batteries (refrigerator)
- 1 x 3-way charge separator
- 1 x 25 AH battery charger
- 220-volt shore power supply

### Drainage

- 1 switch + 1 engine hold pump
- 1 switch + 1 fore shower pump
- 1 switch + 1 keel pump
- 1 switch + 1 propeller compartment pump

### Water

## Estivale Octo

354,000€



- 1,150 litre water tank, incl. 100 litre hot water tank
- Pressurised hot water and cold water with accumulator tank
- Hot water production with 75 litre lagged heat exchanger tank and 220 V electric element (shore power supply)

### Gas

- 2 self-emptying gas compartments for 13 kg cylinders

### Heating

- 1 WEBASTO AIR TOP 40 forced-air heating system and 1 WEBASTO AIR TOP 55 forced-air heating system

### Lighting

- Lighting by wall lights and 12-volt LED spotlights



## Our contact informations

Are you interested in this model and would you like more information? **Do not hesitate to contact us. Nicols**  
Route du Puy Saint Bonnet 49300 Cholet - France **02 41 56 46 56**