



Caractéristiques techniques

Longueur	10.85 mètres
Largeur	3.8 mètres
Couchage recommandé	4
Nombre de cabines	2
Salle de bain / WC	2
Surface séjour	9 m ²
Équipement cuisine	220 L fridge (freezer compartment), Twin-hob stove/oven
Réservoir Eau Potable	750 L
Energie de propulsion	diesel
Réservoir de carburant	315 L
Double pilotage	Yes
Propulseur d'étrave	Yes
Autres équipements	220-volt shore power supply, Air conditioning using shore power, Boarding ladder + outdoor shower, DVD player, Radio CD/MP3, Sun awning, Terrace with garden furniture



The Quattro B+ offers the benefit of a sun awning on the upper deck and air conditioning using shore power

New 2023: To improve onboard comfort even more Nicols has added extra equipment to the Quattro B, with this new model becoming the Quattro B+. The Quattro B+ offers the benefit of a sun awning on the upper deck and air conditioning using shore power.

With its vast front cabin equipped with numerous storage units, an office space and direct access to a private bathroom, it will delight skippers looking for a spacious and comfortable interior.

It comes with an aft **terrace** window level with the living quarters (access via a large sliding bay door), a popular feature that is also included with the Sedan range.

The aft terrace enjoys a deck saloon for outdoor dining, and is equipped with a sun awning if you need protection from the rays!

Also to the aft is the classic gate enabling wide access from a jetty to the terrace. The Estivale range has an extra advantage: two side gates, moulded into the hull, have been added to make it easier to get off the boat from the sides. **Highly practical, particularly for “wild” mooring** »! Simply lay the gangway to disembark onto the bank.

Access to the roof solarium is gained via a moulded stairway + handrail (for comfort and security). The upper deck offers a second jet-ski-style “collapsible” cockpit to facilitate its use while seated on the bench.

To the fore of the boat, a second small terrace moulded into the hull offers a bench and table to make the most of an unobstructed view of the river while sailing.

Lastly, there is a wide range of amenities on board to ensure the greatest possible comfort and convenience: 220-Volt shore power supply, boarding ladder, etc.

[>> View the PDF brochure](#)

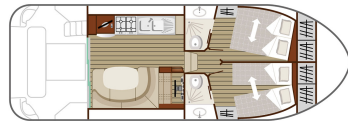
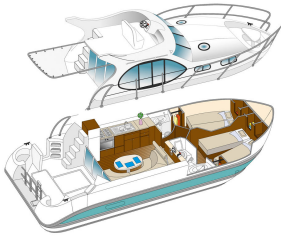



Descriptif technique

MATERIALS

- White-coloured polyester for deck and flying bridge
- White-coloured polyester and sea-green stripe for the hull

INTERIOR MATERIALS

- Partition walls: water-repellent melamine chipboard, "light oak" colour, 16 mm
- Counter-moulded ceiling in polyester, ivory RAL 1013 colour
- Single-unit shower room, polyester, ivory RAL 1013 colour
- PVC floor covering in "medium walnut" colour
- Hull bottom frames and structures: joinery deal and CTBX plywood, 19 and 40 mm
- Mattress and seat top in high-density 10 cm thick foam, covered in leatherette

FITTINGS

- Handrail in stainless steel tubing, diameter 20
- 1 fore railing in 2 sections with intermediary tubing and fore passage (stainless steel, diameter 23)
- 1 aft guardrail with 2 opening gates (stainless steel tubing, diameter 23)
- 2 reinforced chandeliers
- 4 single chandeliers
- 2 rows of railings (sheathed stainless steel) to starboard and port side
- 4 x 250 cleats (anodised alu)
- 4 navigation lights
- 1 port hull spotlight and 1 starboard
- 2 black PVC sheer rails attached to the hull, including 1 at hull/deck connection level (3rd sheer rail as optional extra)
- 2 gangway supports in opening of side gates
- 1 aluminium gangway
- 1 roller support for anchor chain
- 1 polyester table on aluminium base in the fore cockpit
- 1 electric windscreen wiper
- 1 audio warning device

MOTORISATION

- 1 38 CV in-board diesel motor (shaftline) fitted with a mechanical shutter with flexible coupling
- 2 mono-lever gas compartments (main and auxiliary station)
- 1 x 2-station hydraulic steering system
- 1 tachometer
- 1 fuel indicator
- 1 hour meter
- 1 double cockpit
- 1 x 315 L fuel tank
- 1 rudder angle indicator in main station and flying-bridge station
- 1 engine hold with sound-insulating foam



BOW THRUSTER

- 80 kg thruster

INTERIOR EQUIPMENT

Saloon

- 1 two-seat "pilot" bench
- 1 windscreen demisting fan heater
- 1 "C"-shaped bench, convertible into a double bed
- 1 beige coloured polyester table
- 1 electric refrigerator / freezer, 220 L, 220 volts
- 1 twin-bowl sink (120 x 60) with draining board and mixer tap
- 1 twin-hob gas stove, with piezzo electric ignition
- 1 kitchen unit in 16-mm thick "light oak" coloured water-repellent chipboard
- 1 oven (gas-powered)
- 1 automatic bin door under pilot seat
- Various storage units
- 1 x 19-inch LCD colour television with DVD player
- 1 radio CD-MP3 USB player – 2 speakers
- Fabric curtain with blackout lining
- USB port
- 220 V socket

2 bedrooms

- 1 x 140x190 approx. double bed with high-density 15 cm thick foam mattress
- Storage compartment under bed
- Wardrobes
- Storage units
- 1 opening porthole
- 1 round opening deck hatch
- Direct access to shower room and WC
- Fabric curtain with blackout lining
- Bedside lamp
- 220 V socket
- USB port

Bathroom – WC

- 1 mixer tap with built-in adjustable-flow shower head
- 1 beige polyester washbowl
- 1 beige polyester storage unit
- 1 mirror
- Coat hooks
- 1 sliding porthole with opaque film on window
- 1 white plastic-coated shower screen
- 1 electric marine WC
- 1 solar ventilator

EXTERIOR EQUIPMENT

- 1 sliding sun awning
- Mosquito screen on bedroom porthole
- 1 deck shower head accessible from aft platform
- Flying bridge dashboard fitted with a map holder
- 2 exterior lamps
- 1 swimming ladder
- 2 solar ventilators
- 1 hook housing
- 2 polyester side gates
- 1 fixed stairway for flying bridge access

WINDOWS – OPENINGS

- 1 curved safety glass windscreen, 5 mm, in 5 parts, incl. 2 opening
- Saloon sliding bay windows in 4 mm green-tinted safety glass and surrounding profile in lacquered aluminium
- Aft sliding bay window, 3 casements in white lacquered aluminium and clear glass
- Fixed and opening portholes in green-coloured glass
- 2 green-tinted round deck hatches

SERVICES

Energy

- 1 x 100 AH battery (engine starting)
- 2 x 100 AH slow discharge batteries (services)
- 3 x 100 AH slow discharge batteries (refrigerator)
- 1 x 3-way charge separator
- 1 x 25 AH battery charger
- 220-volt shore power supply

Drainage

- 1 switch + 1 engine hold pump
- 1 switch + 1 keel pump
- 1 switch + 1 fore shower pump

Water

- 750 litre water tank, incl. 100 litre hot water tank
- Pressurised hot water and cold water with accumulator tank
- Hot water production with 75 litre lagged heat exchanger tank and electric element (shore power supply)

Waste water

- 2 double organic waste plastic containers with a total capacity of 240 litres

Gas

- 2 self-emptying gas compartments for 13 kg cylinders
- Gas circuit via copper pipe 6/8

Estivale Quattro B +

312,000€



Heating

- 1 WEBASTO AIR TOP 55 forced-air heating system

Lighting

- Via ceiling lights and 12 volt LED spotlights



Nos coordonnées

Vous êtes intéressé par ce modèle et vous souhaitez plus d'informations ? **N'hésitez pas à nous contacter.**
Nicols Route du Puy Saint Bonnet 49300 Cholet - France **02 41 56 46 56**